

cecotec

FORCESILENCE 500/510

Ventilador de pie/Stand fan

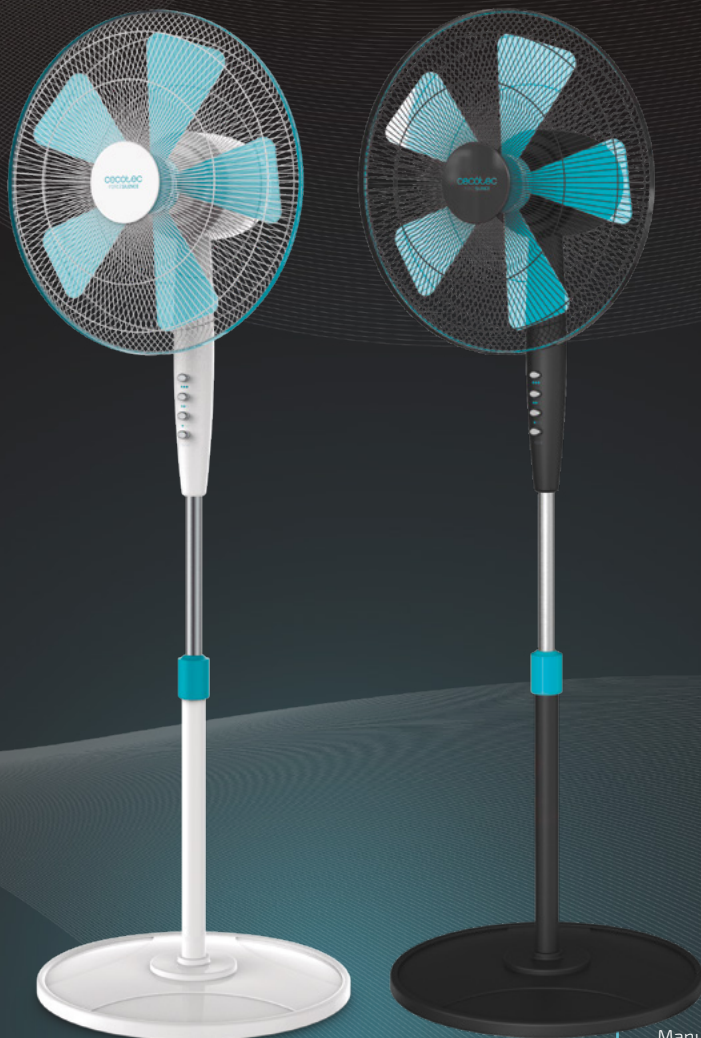

Manual de instrucciones
Instruction manual
Manuel d'instructions
Bedienungsanleitung
Manuale di istruzioni
Manual de instruções
Instrukcja obsługi
Návod k použití

ÍNDICE

1. Piezas y componentes	/ 04
2. Instrucciones de seguridad	/ 06
3. Configuración y montaje	/ 07
4. Funcionamiento	/ 08
5. Limpieza y mantenimiento	/ 08
6. Especificaciones técnicas	/ 08
7. Reciclaje de electrodomésticos	/ 08
8. Garantía y SAT	/ 09

INDEX

1. Parts and components	/ 04
2. Safety instructions	/ 10
3. Setup and configuration	/ 11
4. Operation	/ 11
5. Cleaning and maintenance	/ 12
6. Technical specifications	/ 12
7. Disposal of old electrical appliances	/ 12
8. Technical support service and warranty	/ 12

1. PIEZAS Y COMPONENTES

Parts and components/Pièces et composants/Ersatzteile und Komponenten/
Parti e componenti/Peças e componentes/Części i komponenty/ Části a složení

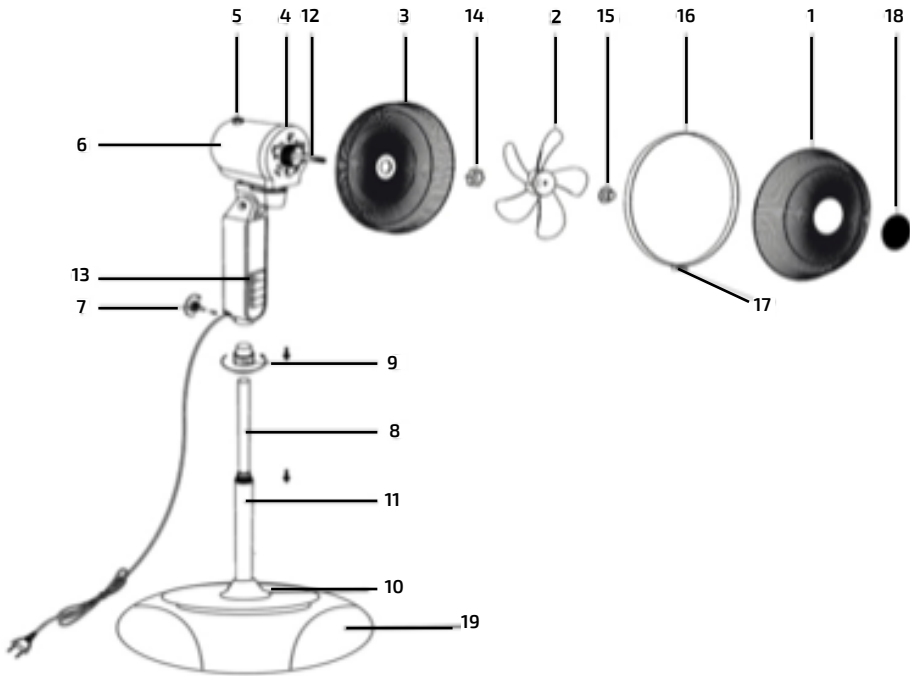

ES

1. Rejilla frontal
2. Aspas
3. Rejilla trasera
4. Tapa del motor
5. Botón de oscilación
6. Motor
7. Rosca para apretar
8. Tubo telescópico
9. Tuerca de ajuste
10. Tapa de la base
11. Tubo de la base
12. Eje central del motor
13. Botones de velocidad
14. Tuerca de la rejilla trasera

15. Tapón de fijación de las aspas

16. Anillo de unión de las rejillas
17. Cierre del anillo
18. Tapa decorativa
19. Base

9. Adjustment screw

10. Base cover
11. Base tube
12. Central hub
13. Fan speed buttons
14. Back grill nut
15. Blade screw
16. Grill ring
17. Ring tighter
18. Decorative cover
19. Base

EN

1. Front grill
2. Blades
3. Back grill
4. Motor cape
5. Oscillation button
6. Motor
7. Screw
8. Telescopic tube

2. SAFETY INSTRUCTIONS

- Never insert fingers, pencils or other objects through the grill when the appliance is running.
- All safety instructions should be closely followed when using the appliance.
- Make sure that the mains voltage matches the voltage stated on the rating label of the appliance

WARNING: Do not immerse the cord, plug, or any non-removable part of the appliance in water or any other liquid, nor expose the electrical connections to water. Make sure your hands are dry before handling the plug or switching on the appliance.

WARNING: if the appliance falls accidentally in water, unplug it immediately. Do not reach into the water!

- Check the power cord regularly for visible damage. If the cord is damaged, it must be replaced by the official Technical Support Service of Cecotec, in order to avoid any type of danger.
- Do not pull or carry the appliance by the cord. Do not use the cord as a handle. Do not pull the cord along sharp edges or corners. Do not run appliance over the cord. Keep the cord away from hot surfaces.

WARNING: do not use the appliance if its cord, plug, or housing is damaged, nor after it malfunctions or has been dropped or damaged in any way.

- Do not use the appliance in confined spaces with explosive or toxic vapours.
- Keep your fan away from heat sources.
- Keep hair, loose clothing, fingers, and other parts of the body away from the openings and moving parts of the appliance.
- The appliance is not intended to be used by children under the age of 8. It can be used by children over the age of 8, as long as they are given continuous supervision.
- This appliance is not intended to be used by persons with reduced physical, sensory, or mental capabilities, or lack of experience or knowledge, unless they have been given supervision or instruction concerning the use of the appliance in a safe way by a person responsible for their safety, and understand the hazards involved.

- Supervise young children to make sure that they do not play with the appliance. Close supervision is necessary when the appliance is being used by or near children.
- Keep the appliance and its cord out of reach of children under the age of 8.
- Do not leave the appliance unattended while in use. Unplug it from the mains supply when you finish using it or when you leave the room.
- Do not try to repair the appliance by yourself. Contact the official Technical Support Service of Cecotec for advice.
- Switch off and unplug from wall outlet when not in use, when moving the appliance from one location to another or before assembling or disassembling parts. To avoid a tripping hazard, safely coil the cable.
- Cleaning and maintenance must be carried out according to this instruction manual to make sure the appliance functions properly. Turn off and unplug the appliance before cleaning it.
- Cleaning and maintenance tasks must not be carried out by children.
- Store the appliance and its instruction manual in a safe and dry place when not in use.
- Make sure the fan is not placed near drapes, curtains, or any objects that may be drawn into the fan
- Do not run cord under carpeting and do not cover cord with throw rugs, runners or the like. Arrange cord away from traffic area and where it will not be tripped over.
- Use the fan in a well-ventilated area. While using, distance of no less than 20cm should be kept away from wall or corner to ensure the air intakes.

3. BEFORE USE

Take out the electric fan from the packing carton and examine the grills and blades, cables and other components, whether they are in good conditions or damaged. In order to use it safely,

- the power must be in accordance with the label in this fan.
 - the power supply must be well installed
 - the product cord adapts correctly in to the power supply.
1. Place the base (19) on a dry stable surface.

ENGLISH

2. Now release the telescopic tube (8) by loosening the adjustment screw (9).
3. Now assemble all the fan pieces together (3, 14, 2 15, 16, 17, 1 and 18) in the central hub (12).
4. Place the motor compartment (6 and 13) and the fan set, and fix both on top of the telescopic tube (8).

4. OPERATION

The fan can only be operated by the manual control located on the fan.

1. To activate the oscillation mode press or push the button (5).
 2. To adjust the fresh air direction, you can move the fan head up or down.
 3. You can adjust the fan speed to desired level:
- 0: Disconnected / 1: Low speed – 2: Medium speed – 3: High speed

5. CLEANING AND MAINTENANCE

1. Always disconnect the appliance from the mains by switching it off and remove the plug from the power outlet before cleaning.
2. Before use every year, please open the motor cover and pour several drops of lubricant oil or sewing machine oil into the motor bearing. Don't use wet cloth to clear the motor unit. Keep the fan clean and store in dry place to avoid moisture.
3. It is advisable to use a neutral detergent and a soft cloth and to rub softly. Do not use solvents, acidic detergents, petrol or alcohol etc., to clean the plastic components as these, could be deformed or damaged.
4. Use a vacuum cleaner to remove the dust from the safety grill. Never take the safety grill away.
5. Do not allow water to penetrate the motor during cleaning.

6. TECHNICAL SPECIFICATIONS

Model: FORCESILENCE 500/510

Product reference: 05201/05202

Power: 40 W

Power Supply: 220-240 V~50 Hz

Made in China | Designed in Spain

7. DISPOSAL OF OLD ELECTRICAL APPLIANCES



The European directive 2012/19/EU on Waste Electrical and Electronic Equipment (WEEE), specifies that old household electrical appliances must not be disposed of with the normal unsorted municipal waste. Old appliances must be collected separately, in order to optimize the recovery and recycling of the materials they

contain, and reduce the impact on human health and the environment.

The crossed out "wheeled bin" symbol on the product reminds you of your obligation to dispose of the appliance correctly. If the product has a built-in battery or uses batteries, they should be removed from the appliance and disposed of appropriately.

Consumers must contact their local authorities or retailer for information concerning the correct disposal of old appliances and/or their batteries.

8. TECHNICAL SUPPORT SERVICE AND WARRANTY

This product is under warranty for 2 years from the date of purchase, as long as the proof of purchase is submitted, the product is in perfect physical condition, and it has been given proper use, as explained in this instruction manual.

The warranty will not cover the following situations:

The product has been used for purposes other than those intended for it, misused, beaten, exposed to moisture, immersed in liquid or corrosive substances, as well as any other fault attributable to the customer.

The product has been disassembled, modified, or repaired by persons, not authorised by the official Technical Support Service of Cecotec.

Faults deriving from the normal wear and tear of its parts, due to use.

The warranty service covers every manufacturing defects of your appliance for 2 years, based on current legislation, except consumable parts. In the event of misuse, the warranty will not apply.

If at any moment you detect any problem with your product or have any doubt, do not hesitate to contact Cecotec Technical Support Service at +34 963 210 728.

www.cecotec.es

Grupo Cecotec Innovaciones S.L.
C/ Pinadeta s/n, 46930
Quart de Poblet, Valencia, Spain

JM02200503